

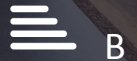

## The Tower

One St George Wharf, SW8 2DA

£1,315 Per Week

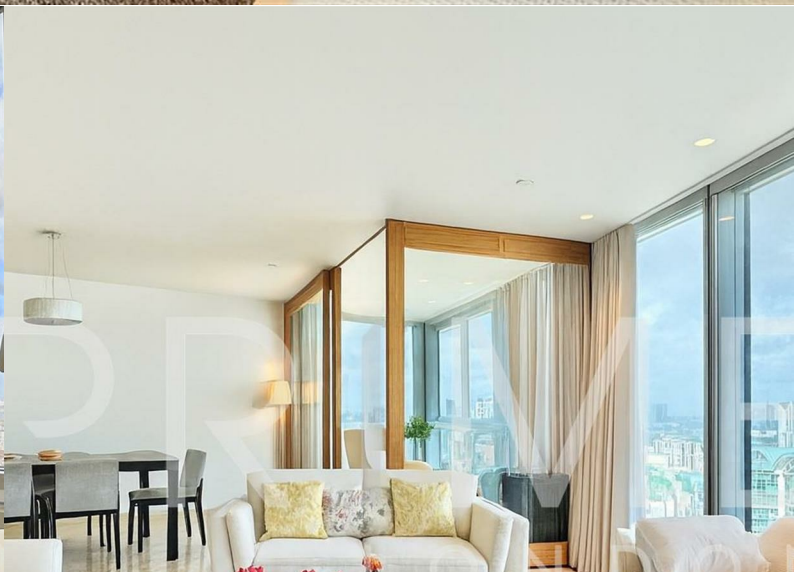



Floor Plan

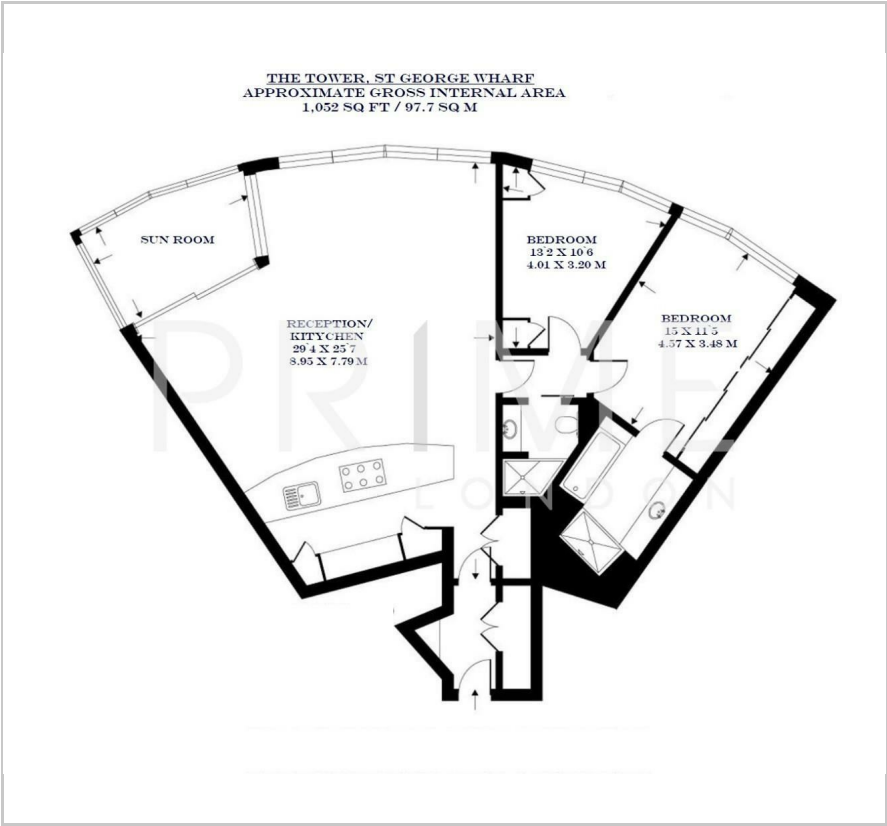

Area Map

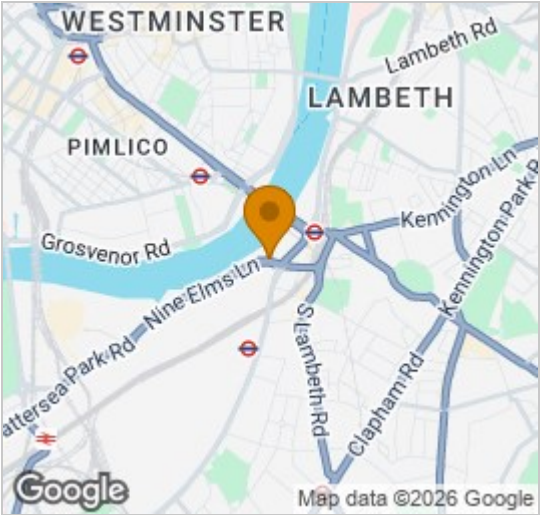

Energy Efficiency Graph

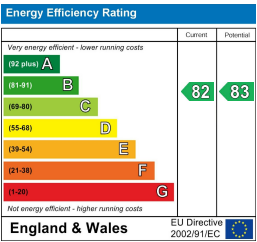

Viewing

By appointment. Contact us on 0207 928 6663 if you wish to arrange a viewing appointment for this property, or require further information.

- Two bedroom apartment
- 1,052 sq ft (97.7 sqm)
- Exceptional views
- Fully furnished
- Cinema, gym, pool and sauna
- 24 hour concierge facilities



This exceptional two bedroom apartment of 1,052 sq ft (97.7 sqm), located on a higher floor in the iconic St George Wharf Tower on the River Thames, comes fully furnished and is available to rent through Prime London. The property also comes with valet parking.

The property offers stunning views across London and its features include marble, glass and walnut finishes throughout while the master suite benefits from a full wall of integrated storage and en suite. The apartment also boasts its own sky garden balcony, fully comprehensive kitchen with Miele appliances, modern bathrooms and valet parking.

Amenities include front door concierge with valet parking, first floor gym, pool and sauna facilities as well as a private cinema. St George Wharf offers on site riverside bars and restaurants such as Waterfront London, The Riverside, Four Degree and Pop Art Sushi as well as direct access to Vauxhall Underground Station on the Victoria Line.

For additional convenience other on site outlets include Tesco Express, Pret a Manger, Hudson's Dry Cleaners, Riverside Medical Centre, Dental Spa and more.



These particulars, whilst believed to be accurate are set out as a general outline only for guidance and do not constitute any part of an offer or contract. Intending purchasers should not rely on them as statements of representation of fact, but must satisfy themselves by inspection or otherwise as to their accuracy. No person in this firms employment has the authority to make or give any representation or warranty in respect of the property.