

One Thames City

8 Carnation Way, Nine Elms, SW8 5JD

£923 Per Week



Floor Plan

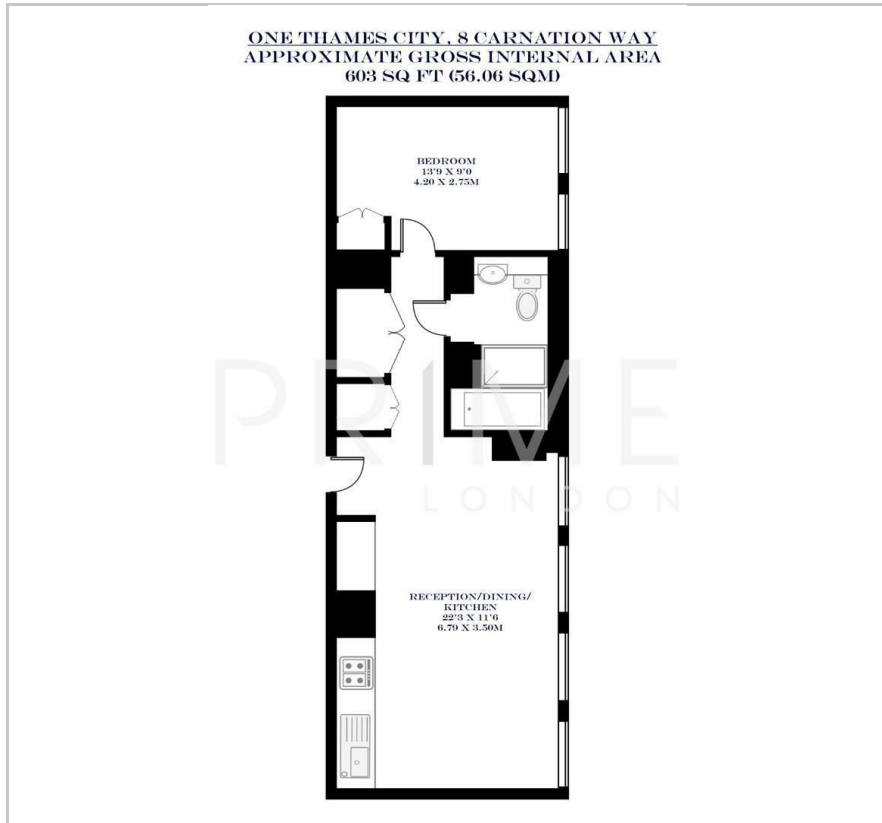

Area Map

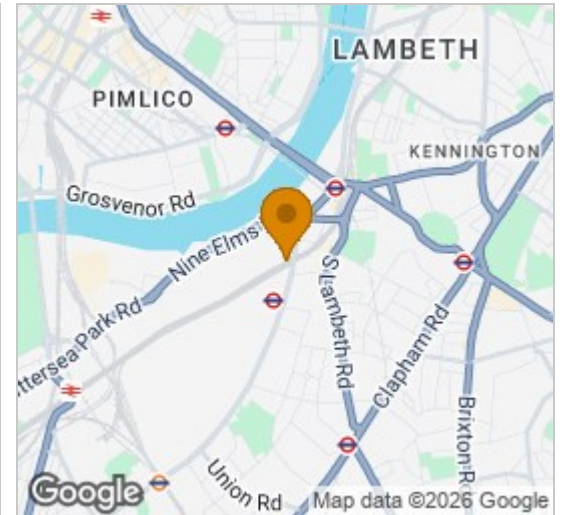

Energy Efficiency Graph



Viewing

By appointment. Contact us on 0207 928 6663 if you wish to arrange a viewing appointment for this property, or require further information.

- Stunning one bedroom ▪ 603 sq ft (56.06 sqm) apartment
- 30 metre swimming pool, spa, Residents' state of the art sauna, and treatment rooms
- Cinema room, library, sky lounge, karaoke room and kids club



With excellent natural light and access to superb residents' facilities, this exceptional one bedroom apartment of 603 sq ft (56.06 sqm) is set in a prime position within the sought after One Thames City development, and is available to lease through Prime London.

Thoughtfully designed to maximise space, the apartment is bright and contemporary, with floor to ceiling windows drawing in excellent natural light. The kitchen and bathroom are finished to a high standard, with refined detailing throughout, creating a stylish and comfortable home.

Multiple amenity spaces have been designed to calm and inspire include an elegant lobby with a 24 hour concierge, a wellness centre that includes a 30 metre swimming pool, spa, sauna, treatment rooms, a fully-equipped gym, a private cinema room, a library, private dining, lounge area, a sky lounge, karaoke room and kids club.

Located next to the River Thames and a only a few minutes walk from both Nine Elms Underground station and Vauxhall transport hub means getting around the city couldn't be simpler. The Thames Clipper service is also nearby.



These particulars, whilst believed to be accurate are set out as a general outline only for guidance and do not constitute any part of an offer or contract. Intending purchasers should not rely on them as statements of representation of fact, but must satisfy themselves by inspection or otherwise as to their accuracy. No person in this firm's employment has the authority to make or give any representation or warranty in respect of the property.