

The Wilderly

Ash Avenue, Elephant Park, SE17 1HS

Asking Price £650,000



0



1



1



B

Floor Plan

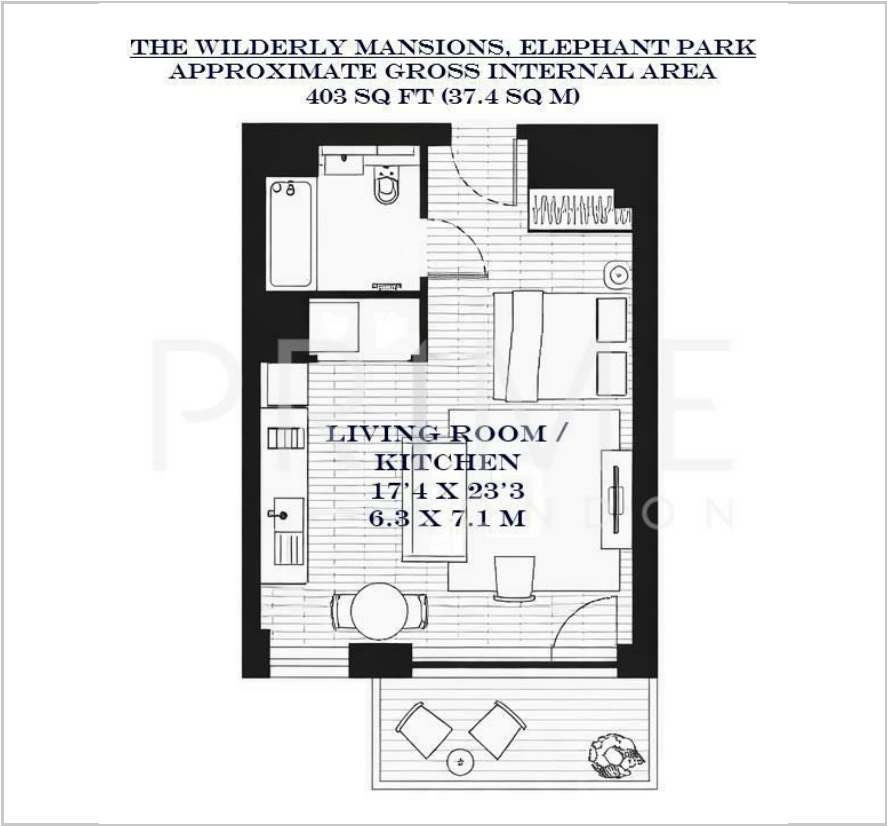

Area Map



Energy Efficiency Graph

Viewing

By appointment. Contact us on 0207 928 6663 if you wish to arrange a viewing appointment for this property, or require further information.

- Studio apartment
- Residents' communal gardens
- 24 hour concierge
- 403 sq ft (37.4 sqm)
- Just 3 minutes' walk to Elephant and Castle Station
- *Images are of the show apartment, for representation of specification and finishes*



This beautifully presented studio apartment, spanning 403 sq ft (37.4 sqm), within the sought after Wilderly Tower at Elephant Park, is available for sale through Prime London.

The property features a bright open plan reception space with full height windows, alongside a bespoke modern kitchen with integrated appliances. A private south facing balcony provides the perfect outdoor extension to the living area.

Residents benefit from a comprehensive suite of amenities, including a concierge, co-working lounge, wellness studio, landscaped private garden, roof terraces, and a 24th-floor lounge and dining space with panoramic views across London. The development has been carefully planned to balance social and relaxation spaces, with interiors and communal areas inspired by the surrounding parkland.

Positioned moments from Elephant & Castle Underground and rail stations, The Wilderly offers excellent connectivity across the capital, with direct access to the Northern and Bakerloo lines as well as Thameslink services. Many of London's major cultural landmarks, universities, and the South Bank are within a short walk, reinforcing its appeal to both owner-occupiers and investors.

Set within Elephant Park's 11 acres of landscaped green space, the development forms part of a vibrant mixed-use neighbourhood with independent restaurants, cafés, retail, leisure facilities, and educational



These particulars, whilst believed to be accurate are set out as a general outline only for guidance and do not constitute any part of an offer or contract. Intending purchasers should not rely on them as statements of representation of fact, but must satisfy themselves by inspection or otherwise as to their accuracy. No person in this firm's employment has the authority to make or give any representation or warranty in respect of the property.