

## Globe View

10 High Timber Street, St Paul's, EC4V 3PL

Asking Price £475,000



## Floor Plan

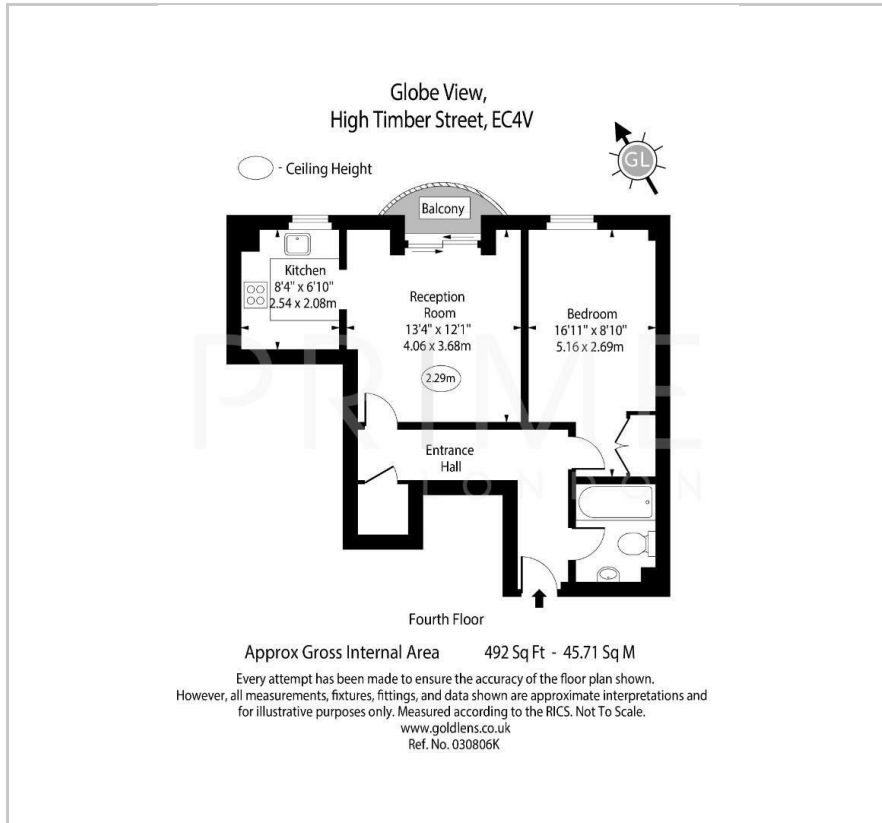

## Area Map

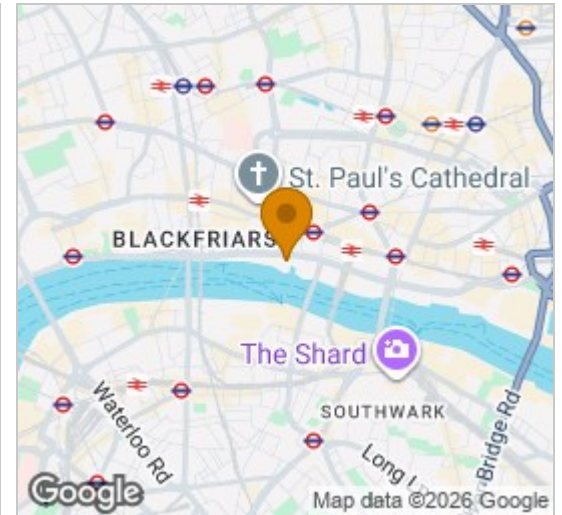

## Energy Efficiency Graph

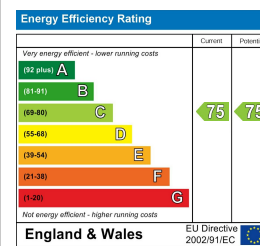

## Viewing

By appointment. Contact us on 0207 052 1075 if you wish to arrange a viewing appointment for this property, or require further information.

- Superbly located
- Share of Freehold
- 492 sq ft (45.7 sqm)
- Day porter



This well designed 492 sq ft (45.7 sqm) apartment, on a high floor in Globe View, is available to purchase through Prime London.

Superbly located in the heart of the City, the property comprises a spacious reception room with a fully fitted open plan kitchen, leading onto a private balcony. The bedroom benefits from fitted wardrobe space, while a modern bathroom is conveniently located off the hallway.

Further benefits include a concierge service, secure entry system, and the property is offered to the market with no onward chain.

Globe View is ideally positioned close to St Paul's Cathedral, with excellent transport links nearby including Mansion House (Circle & District lines), Blackfriars (Circle & District lines), St Paul's (Central line), as well as the Elizabeth Line accessible from Moorgate and Farringdon stations.



These particulars, whilst believed to be accurate are set out as a general outline only for guidance and do not constitute any part of an offer or contract. Intending purchasers should not rely on them as statements of representation of fact, but must satisfy themselves by inspection or otherwise as to their accuracy. No person in this firm's employment has the authority to make or give any representation or warranty in respect of the property.