

## Kings Gate

1 Kings Gate Walk, St James's Park, SW1E 6AN

£1,400 Per Week



## Floor Plan

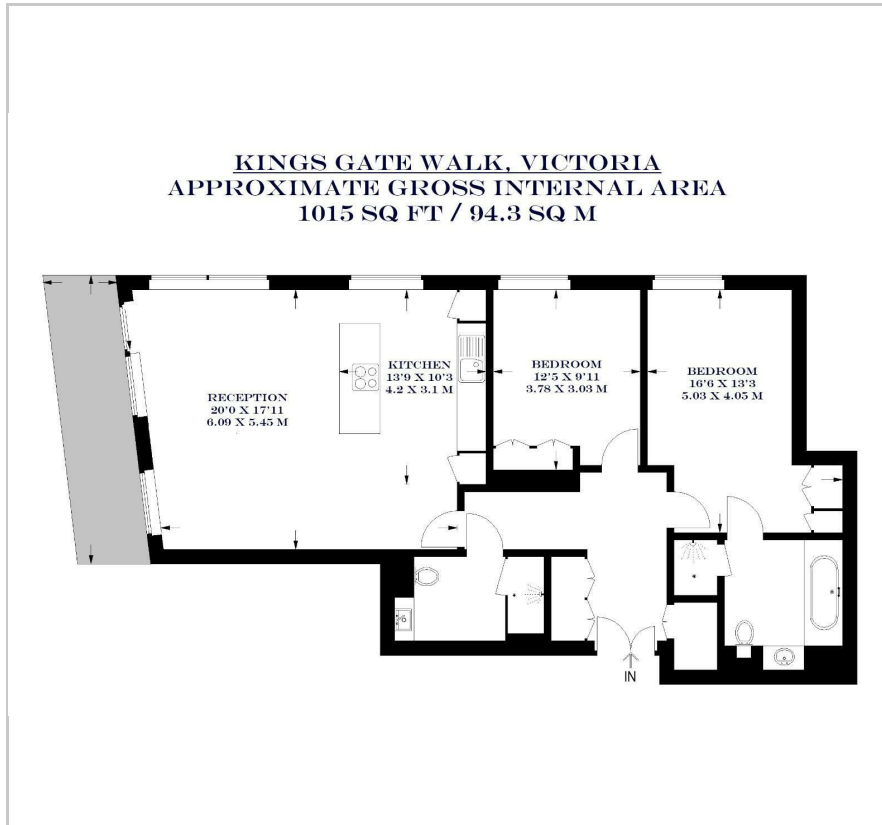

## Area Map



## Energy Efficiency Graph

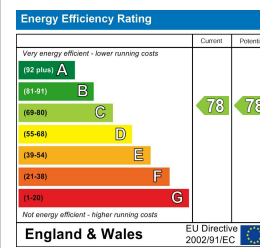

## Viewing

By appointment. Contact us on 0207 052 1075 if you wish to arrange a viewing appointment for this property, or require further information.

- Exceptional two bedroom ▪ 1,015 sq ft (94.3 sqm) apartment
- Open plan reception/kitchen ▪ Private balcony
- Furnished ▪ 24 hour concierge



This well appointed two bedroom apartment, in the highly sought-after Kings Gate Walk development, is available for lease through Prime London.

Totalling 1,015 sq ft (94.3 sqm) the property boasts a generous open plan reception with floor to ceiling windows which open up to a private balcony. The kitchen is fully fitted with integrated appliances. Both bedrooms are spacious, offering a modern stylish design, under floor heating and electrically operated blinds. The master bedroom benefits from its own ensuite.

The apartment is located within the highly sought after Kings Gate development in the heart of Victoria, which offers 24 hour concierge services and is just a short walk away from some of London's best restaurants, cafes and boutiques.

For transportation, Victoria and St James's Park stations are just a stone's throw away and offer excellent transport links across the city and beyond.



These particulars, whilst believed to be accurate are set out as a general outline only for guidance and do not constitute any part of an offer or contract. Intending purchasers should not rely on them as statements of representation of fact, but must satisfy themselves by inspection or otherwise as to their accuracy. No person in this firm's employment has the authority to make or give any representation or warranty in respect of the property.