



## Nova Building

79 Buckingham Palace Road, SW1W 0AJ

Asking Price £1,700,000



## Floor Plan

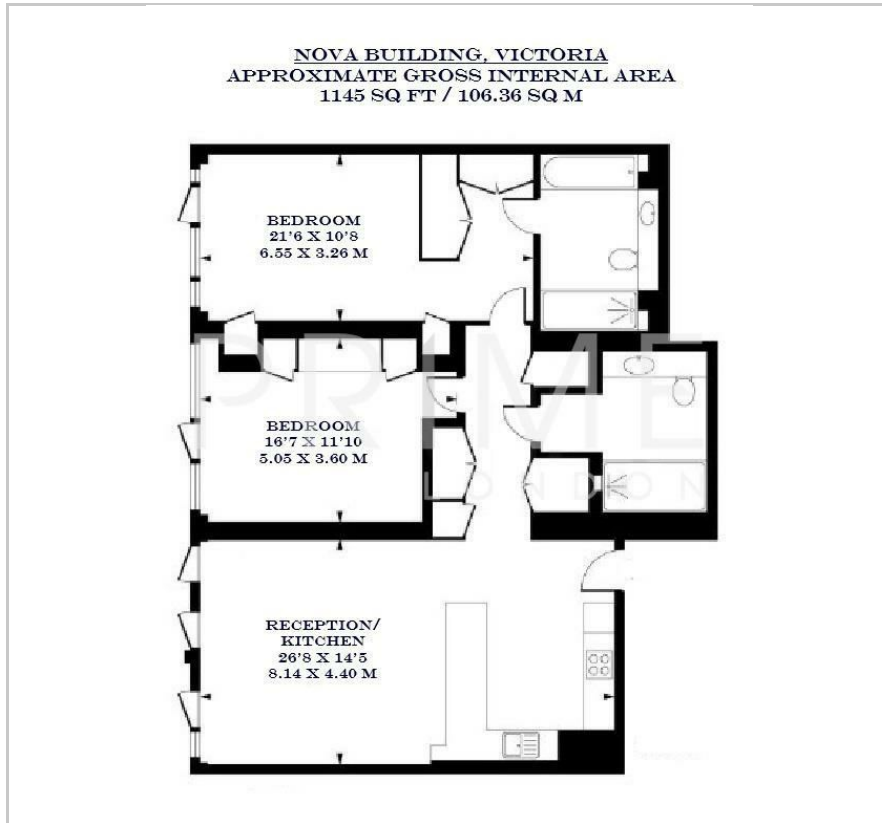

## Area Map



## Energy Efficiency Graph



## Viewing

By appointment. Contact us on 0207 052 1075 if you wish to arrange a viewing appointment for this property, or require further information.

- Exceptional two bedroom ▪ 1145 sq ft (106 sqm) apartment
- Master bedroom with ensuite ▪ Open plan reception
- Residents only gym, roof ▪ 24 hour concierge terrace and cinema room



This exceptional two bedroom apartment, located in the highly sought after Nova Building, is available for chain free sale through Prime London.

Totalling 1,145 sq ft (106 sqm), the property boasts a modern open plan reception and dining area with floor to ceiling windows allowing for excellent natural light throughout. Both bedrooms are modern and spacious with built-in wardrobes. The master bedroom features a modern sleek ensuite.

The apartment is situated within the Nova Building development, which offers residents a private gym, residents' lounge, roof terrace, cinema room, and meeting rooms. This also includes a 24 hour concierge service.

Positioned in the heart of Victoria, the apartment has easy access to some of London's most iconic landmarks, including Buckingham Palace, Westminster Cathedral, and the Houses of Parliament.

For transport, Victoria station is just a stone's throw away and provides excellent transport links across the city.



These particulars, whilst believed to be accurate are set out as a general outline only for guidance and do not constitute any part of an offer or contract. Intending purchasers should not rely on them as statements of representation of fact, but must satisfy themselves by inspection or otherwise as to their accuracy. No person in this firm's employment has the authority to make or give any representation or warranty in respect of the property.