

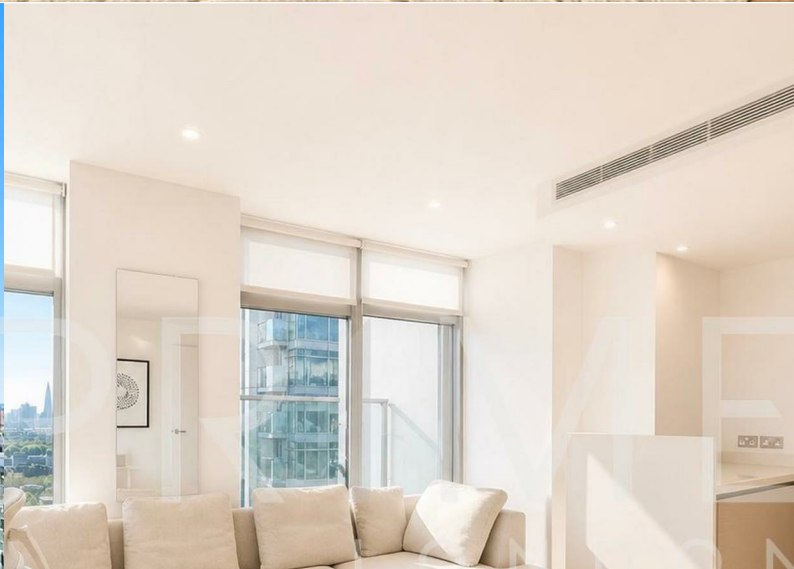

Pan Peninsula Square

Canary Wharf, E14 9HQ

Asking Price £575,000



Floor Plan

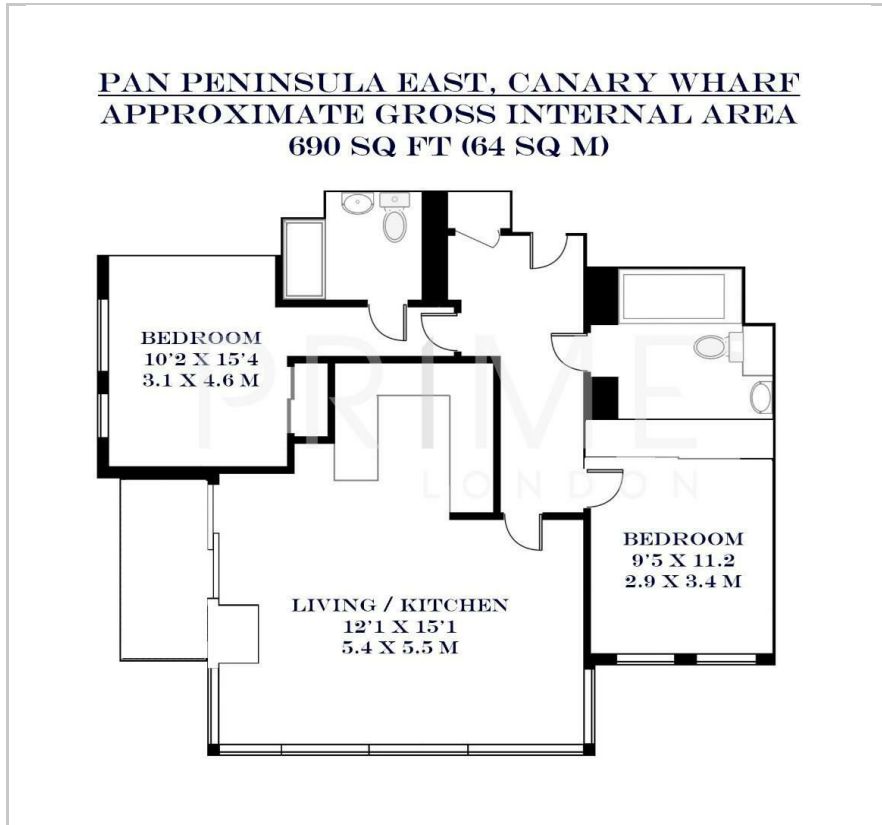

Area Map



Energy Efficiency Graph

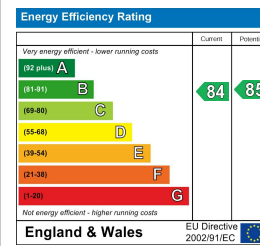

Viewing

By appointment. Contact us on 0207 928 6663 if you wish to arrange a viewing appointment for this property, or require further information.

- Two bedroom apartment
- 690 sq ft (64 sqm)
- Private balcony with exceptional views
- Secure parking
- 24 hour concierge
- Residents' gym and pool
- Cinema room

This stunning two bedroom apartment, with secure parking, spanning 690 sq ft (64 sqm) within the well sought-after Pan Peninsula Square development in Canary Wharf, is available for sale through Prime London.

The property offers a spacious open-plan reception and kitchen area with floor-to-ceiling windows, with direct access to a private balcony offering views of the river. Both bedrooms are well-proportioned, accommodating a double bed as well as built-in storage. The principal bedroom benefits from an en-suite bathroom, in addition to a modern bathroom located off the hallway, alongside additional storage provisions.

Residents enjoy access to outstanding on-site facilities, including a 24 hour concierge, exclusive gym, swimming pool, cinema and residents' lounge.

Ideally located in Canary Wharf, Europe's pre-eminent financial hub, Pan Peninsula is within a few minutes walk of central Canary Wharf and enjoys unparalleled transport connections. These include the Jubilee Line, Crossrail, Docklands Light Railway, Thames Clipper boat services and European flights via London City Airport.



These particulars, whilst believed to be accurate are set out as a general outline only for guidance and do not constitute any part of an offer or contract. Intending purchasers should not rely on them as statements of representation of fact, but must satisfy themselves by inspection or otherwise as to their accuracy. No person in this firm's employment has the authority to make or give any representation or warranty in respect of the property.