



Principal Tower

2 Worship Street, Shoreditch, EC2A 2FF

£1,108 Per Week



Floor Plan

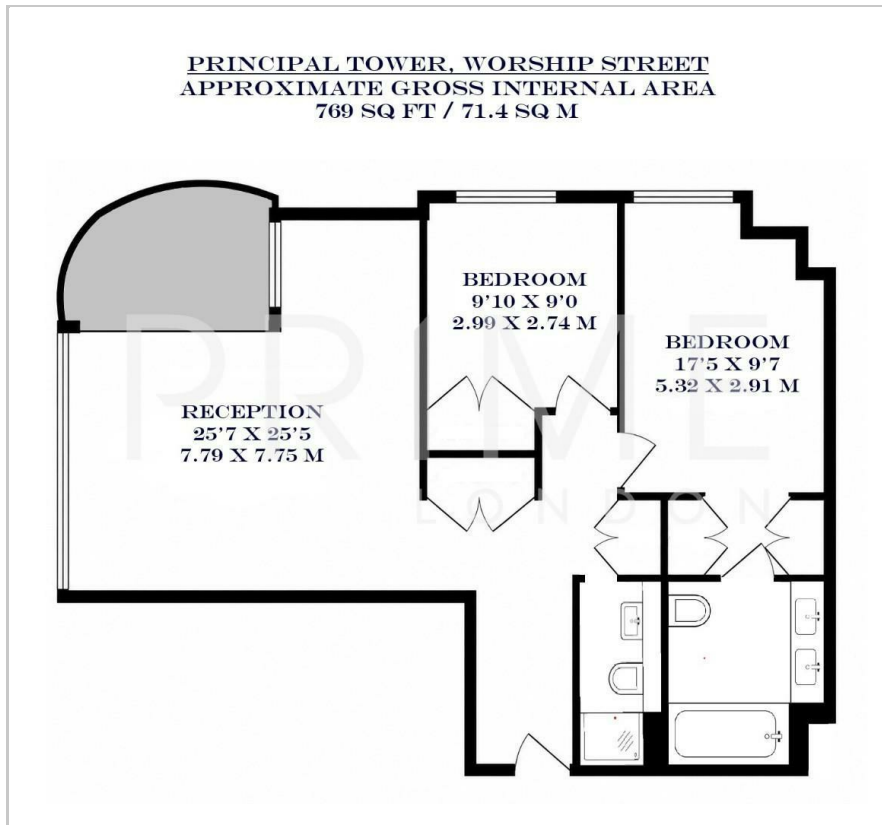

Area Map



Energy Efficiency Graph



Viewing

By appointment. Contact us on 0207 052 1075 if you wish to arrange a viewing appointment for this property, or require further information.

- Exceptional two bedroom ▪ 769 sq ft (71.4 sqm) apartment
- Private balcony ▪ Master bedroom with ensuite
- Residents only gym, pool, spa ▪ 24 hour concierge and meeting/cinema rooms



This exceptional high floor two bedroom apartment, located in the highly sought after Principal Tower, is available for lease through Prime London.

Totalling 769 sq ft (71.4 sqm) the property boasts a generous open plan reception and fully fitted kitchen area, with floor to ceiling windows and access to a private balcony that provides panoramic views of the city skyline. Both bedrooms are modern and spacious with built-in wardrobes. The master bedroom features a modern sleek ensuite.

The apartment is located within the luxurious Principal Tower, which offers residents a private gym, swimming pool, spa, meeting/cinema rooms and 24 hour concierge.

Located in the vibrant area of Liverpool Street, the apartment is located in the city's financial district, and surrounded by a selection of restaurants, shops and cafes.

For transportation, Liverpool Street and Shoreditch High Street stations are just a stone's throw away and offer excellent transport links across the city.



These particulars, whilst believed to be accurate are set out as a general outline only for guidance and do not constitute any part of an offer or contract. Intending purchasers should not rely on them as statements of representation of fact, but must satisfy themselves by inspection or otherwise as to their accuracy. No person in this firm's employment has the authority to make or give any representation or warranty in respect of the property.