

## Hepworth Court

Gatliff Road, Grosvenor Waterside, SW1W 8QP

Asking Price £790,000



1



1



1



B

## Floor Plan

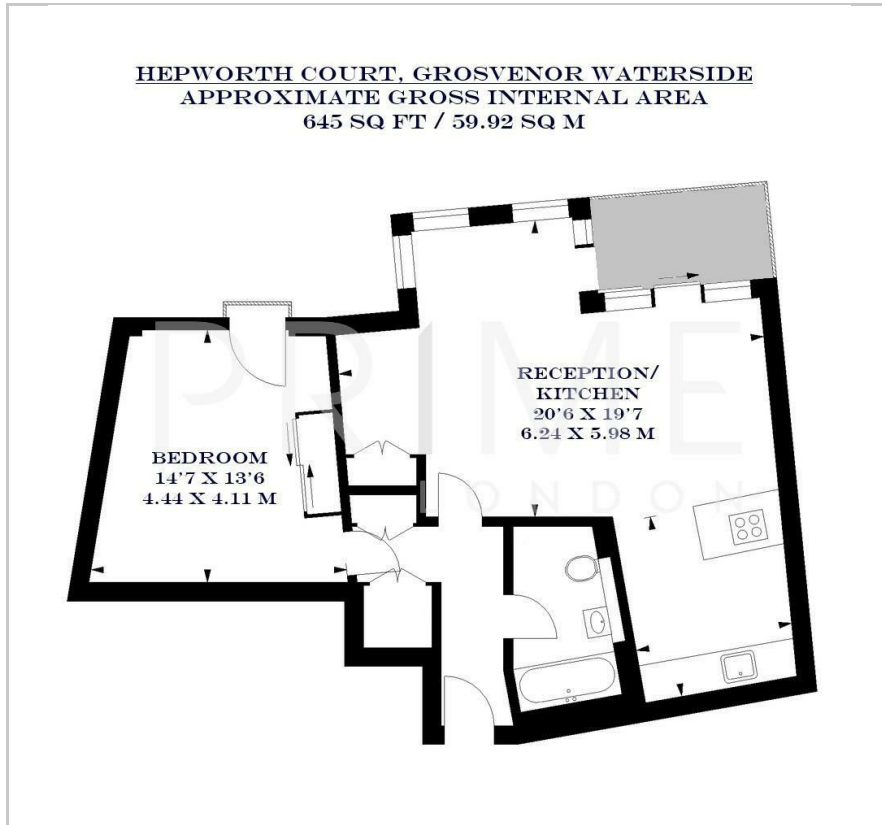

## Area Map



## Energy Efficiency Graph

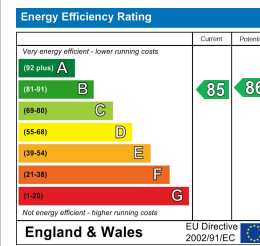

## Viewing

By appointment. Contact us on 0207 052 1075 if you wish to arrange a viewing appointment for this property, or require further information.

- Exceptional one bedroom apartment
- 645 sq ft (60 sq m)
- Private parking space
- Residents only luxury spa and gym
- Open plan reception and kitchen area
- 24 hour concierge



This exceptional one bedroom apartment, with secure parking, located in the highly sought after Grosvenor Waterside development, is available for lease through Prime London.

Totalling 645 sq ft (60 sqm), the property boasts a generous open plan reception and kitchen area with floor to ceiling windows spanning across the length of the property, allowing for excellent natural light throughout. The bedroom is modern and spacious, with a fitted built in wardrobe. The apartment also benefits from a cooling system and a private balcony.

Residents of this sought-after development enjoy access to a range of on-site facilities, including a 24 hour concierge, a luxury spa and gym.

Located in the prestigious area of Chelsea, the apartment is situated near some of London's best restaurants, cafes and boutiques.

For transport, Hepworth Court is just a stone's throw away from Sloane Square station, which has excellent transport links across the city.

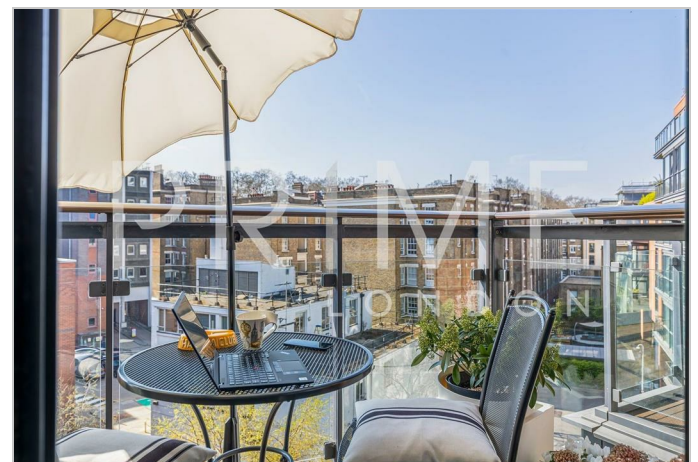

These particulars, whilst believed to be accurate are set out as a general outline only for guidance and do not constitute any part of an offer or contract. Intending purchasers should not rely on them as statements of representation of fact, but must satisfy themselves by inspection or otherwise as to their accuracy. No person in this firm's employment has the authority to make or give any representation or warranty in respect of the property.