



## The Tower

One St George Wharf, Vauxhall, SW8 2DA

£2,300 Per Week



## Floor Plan

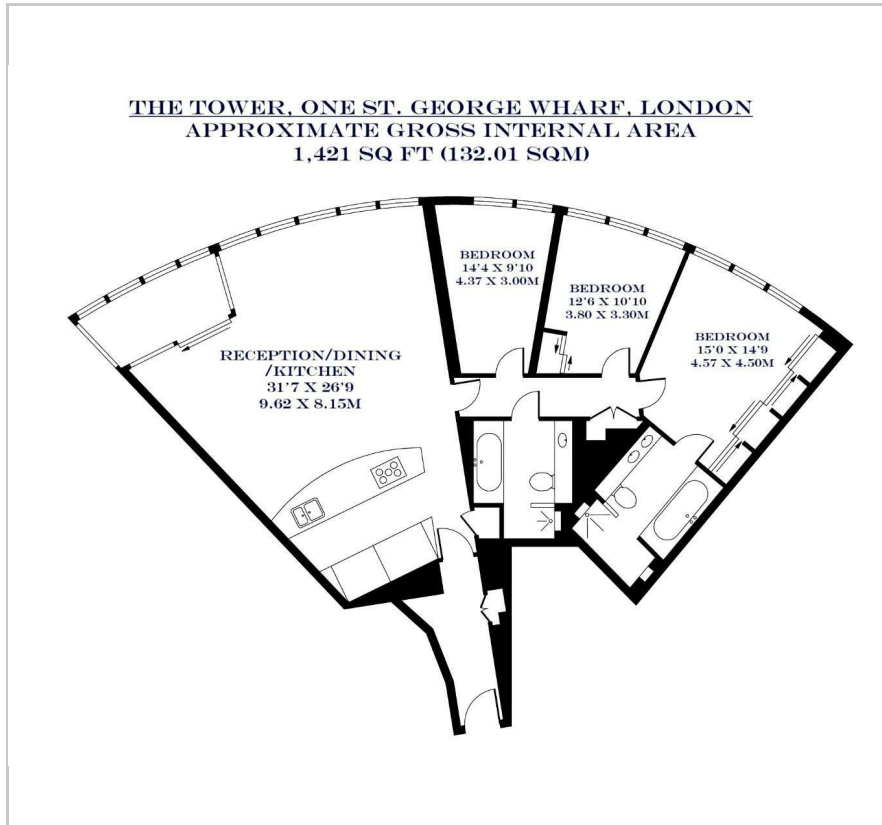

## Area Map

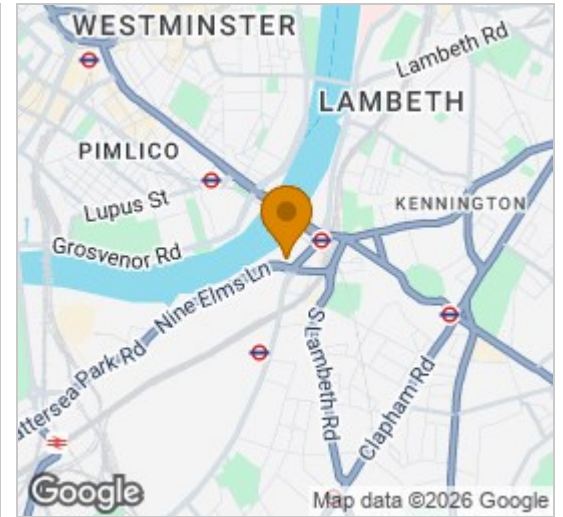

## Energy Efficiency Graph

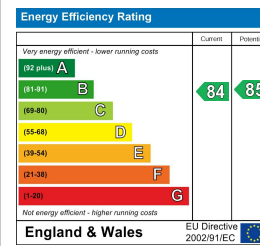

## Viewing

By appointment. Contact us on 0207 928 6663 if you wish to arrange a viewing appointment for this property, or require further information.

- Stunning apartment
- Beautifully furnished
- Stunning panoramic views
- 1,423 sq ft (132 sqm)
- Valet parking
- Gym, Pool and Sauna facilities



Beautifully furnished and finished to an excellent standard, with a stunning panoramic view of London and set next to the River Thames, this luxurious 1,423 sq ft (132 sqm) three bedroom apartment is available to rent through Prime London.

The property also comes with valet parking.

The apartment offers a large living space with floor to ceiling windows, a fully integrated kitchen with Miele appliances and breakfast bar, three double bedrooms (all with stunning views), two high specification bathrooms with exquisite stone work, comfort cooling, touch panel controls, recessed lighting and automated winter garden.

Amenities include front door concierge, first floor gym, pool and sauna facilities as well as a private cinema. St George Wharf offers on site riverside bars and restaurants such as Waterfront London, The Riverside, Four Degree and Pop Art Sushi as well as direct access to Vauxhall Underground Station on the Victoria Line.

For additional convenience other on site outlets include Tesco Express, Pret a Manger, Hudson's Dry Cleaners, Riverside Medical Centre & Dental Spa and more.



These particulars, whilst believed to be accurate are set out as a general outline only for guidance and do not constitute any part of an offer or contract. Intending purchasers should not rely on them as statements of representation of fact, but must satisfy themselves by inspection or otherwise as to their accuracy. No person in this firm's employment has the authority to make or give any representation or warranty in respect of the property.