

One Crown Place

19 Sun Street, EC2A 2FJ

£900 Per Week

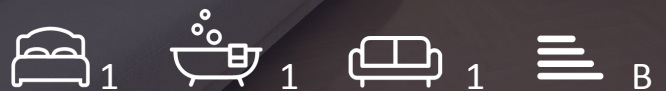

Floor Plan

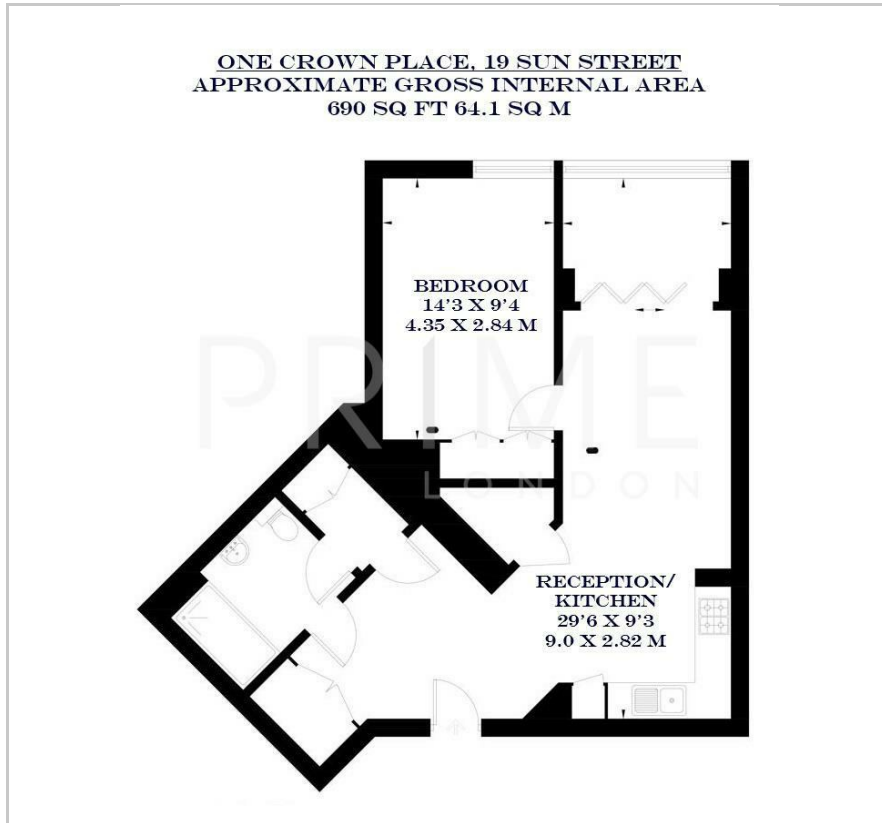

Area Map



Energy Efficiency Graph

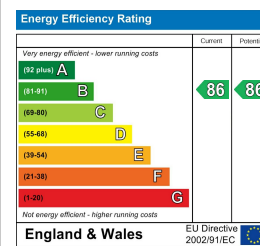

Viewing

By appointment. Contact us on 0207 052 1075 if you wish to arrange a viewing appointment for this property, or require further information.

- Exceptional one bedroom ▪ 690 sq ft (64.1 sqm) apartment
- Open plan reception ▪ Residents only gym, cinema and terrace
- Winter garden ▪ 24 hour concierge

This exceptional one bedroom apartment, located in the highly sought after One Crown Place development, is available for lease through Prime London.

Totalling 690 sq ft (64.1 sqm), the property boasts a generous open plan reception area and fully fitted kitchen with integrated appliances. A key feature of this apartment is the winter garden, which showcases floor to ceiling windows, allowing for excellent natural light throughout. The master bedroom benefits from built in wardrobe space and underfloor heating and cooling systems.

The property is situated within One Crown Place, which offers its resident a private gym, cinema, terrace, and 24 hour concierge services.

For transport, One Crown Place, is just a short walk away from Liverpool Street Station, which offers excellent transport links across the city.



These particulars, whilst believed to be accurate are set out as a general outline only for guidance and do not constitute any part of an offer or contract. Intending purchasers should not rely on them as statements of representation of fact, but must satisfy themselves by inspection or otherwise as to their accuracy. No person in this firm's employment has the authority to make or give any representation or warranty in respect of the property.