



Thirty Casson Square

Southbank Place, SE1 7DY

£1,400,000



Floor Plan

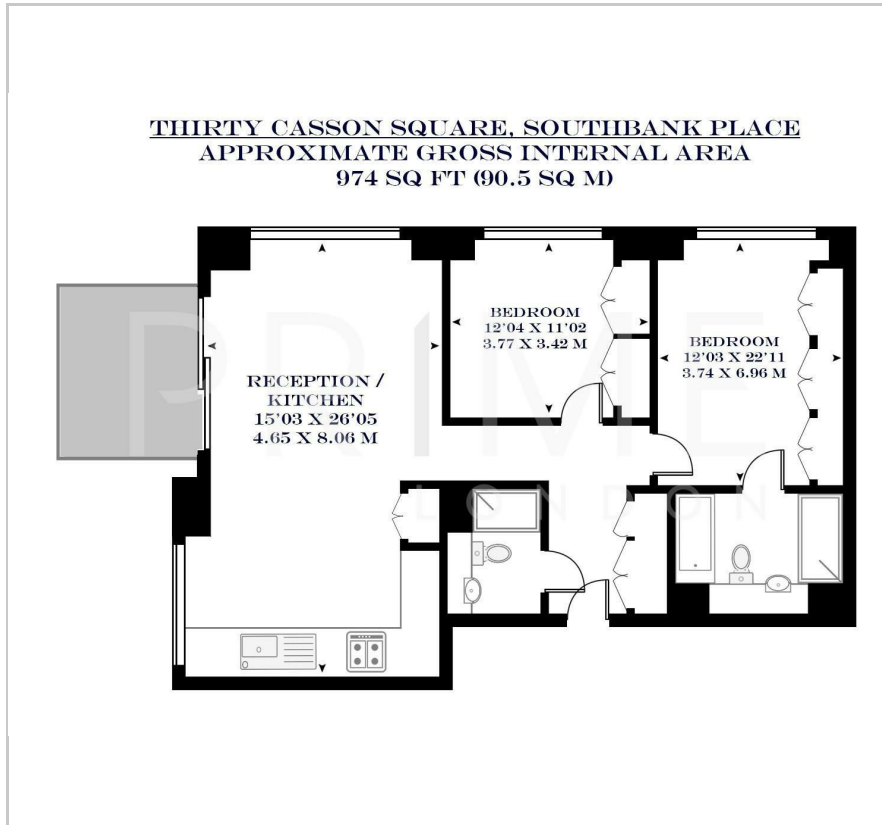

Area Map



Energy Efficiency Graph



Viewing

By appointment. Contact us on 0207 928 6663 if you wish to arrange a viewing appointment for this property, or require further information.

- Beautiful two bedroom ▪ 974 sq ft (90.5 sqm) apartment
- Dual aspect with a private ▪ Residents' leisure facilities balcony
- Exclusive residents lounge ▪ 24 hour concierge and private dining area



An ideal Central London two bedroom apartment, finished to the highest specification, available for sale in Thirty Casson Square, Southbank Place, through Prime London.

The apartment offers 974 sq ft (90.5 sqm) of internal space, a private balcony, and benefits from having a spacious dual aspect lounge and excellent finishes throughout.

Apartment interiors blend traditional and modern approaches with combinations of high quality natural materials creating a harmonious and durable feel.

The apartment also benefits from luxurious bathrooms, finished with polished stone throughout and high specification fittings and Dornbracht brassware.

Residents at Southbank Place benefit from the highest quality of living, with access to the residents' only amenities floor, which includes his and hers steam and sauna rooms, a gymnasium, a 25 metre swimming pool, treatment rooms, wet room and gym classes.

Additionally, the development includes 48,000 sq. ft. of shops, restaurants and bars, and a direct entrance to London Waterloo Station.



These particulars, whilst believed to be accurate are set out as a general outline only for guidance and do not constitute any part of an offer or contract. Intending purchasers should not rely on them as statements of representation of fact, but must satisfy themselves by inspection or otherwise as to their accuracy. No person in this firm's employment has the authority to make or give any representation or warranty in respect of the property.