



Arena Tower

25 Crossharbour Plaza, Canary Wharf, E14 9SS

Asking Price £525,000



Floor Plan

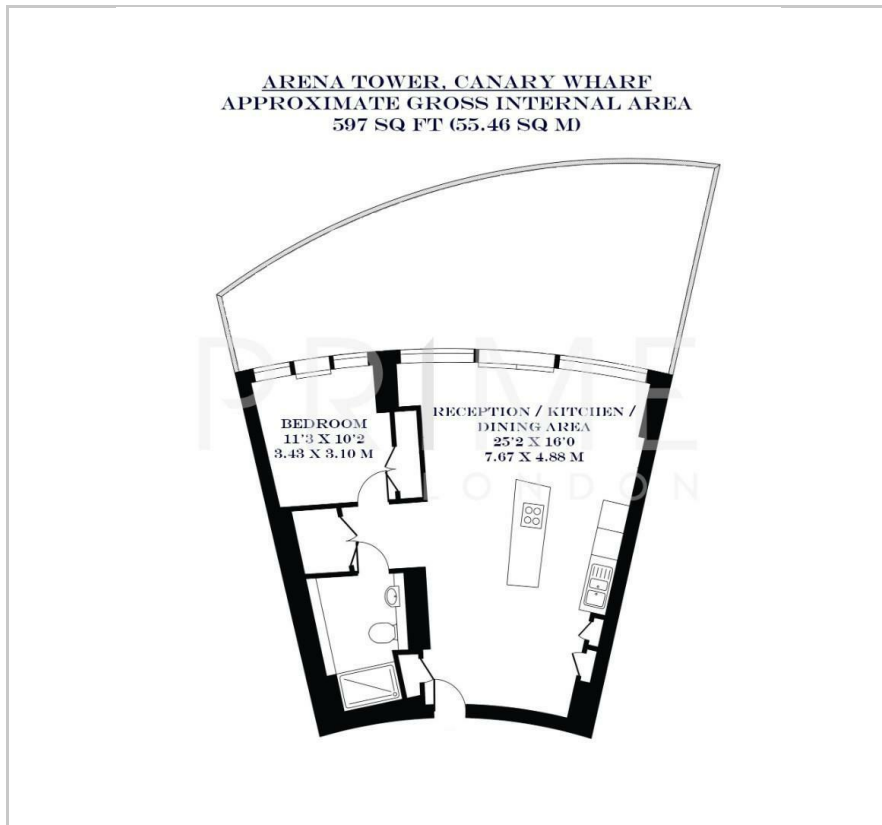

Area Map



Energy Efficiency Graph



Viewing

By appointment. Contact us on 0207 928 6663 if you wish to arrange a viewing appointment for this property, or require further information.

- One bedroom apartment
- 597 sq ft (55.46 sqm)
- 24 hour concierge
- Residents gym and swimming pool



This stylish one bedroom apartment, with 597 sq ft (55.46 sqm) of internal space in the sought after Arena Tower, is available for sale through Prime London.

This bright and modern apartment features a high-specification interior with a spacious open-plan reception area, seamlessly extending onto a full-width balcony/terrace. The generously sized bedroom includes built-in wardrobes, complemented by a beautifully appointed three-piece bathroom suite and ample storage throughout the home.

Residents of Arena Tower enjoy an impressive range of on-site amenities, including a 24 hour concierge service, a private cinema, and exclusive access to the Nuffield Health gym at Baltimore Wharf. This expansive, two-level facility boasts a wide array of cardio and strength-training equipment, free weights, and even a boxing ring.

Additionally, residents benefit from access to a 25 metre indoor swimming pool - one of only three full-length pools available in Canary Wharf residential developments.



These particulars, whilst believed to be accurate are set out as a general outline only for guidance and do not constitute any part of an offer or contract. Intending purchasers should not rely on them as statements of representation of fact, but must satisfy themselves by inspection or otherwise as to their accuracy. No person in this firm's employment has the authority to make or give any representation or warranty in respect of the property.