



Warren House

Warwick Road, Kensington, W14 8TR

£912 Per Week



Floor Plan

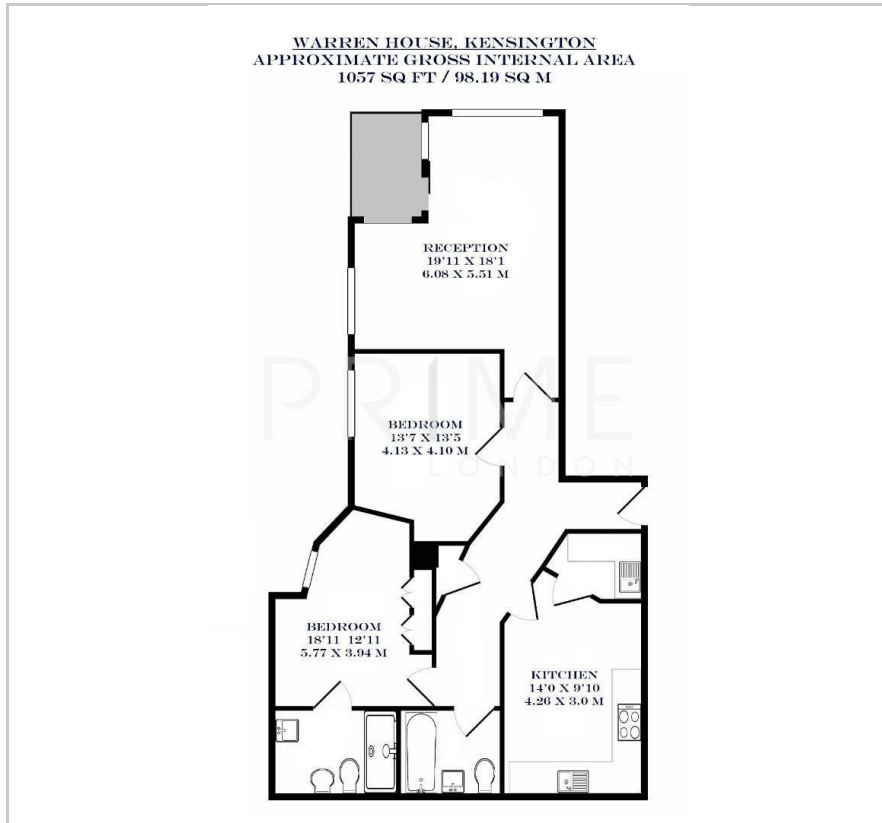

Area Map

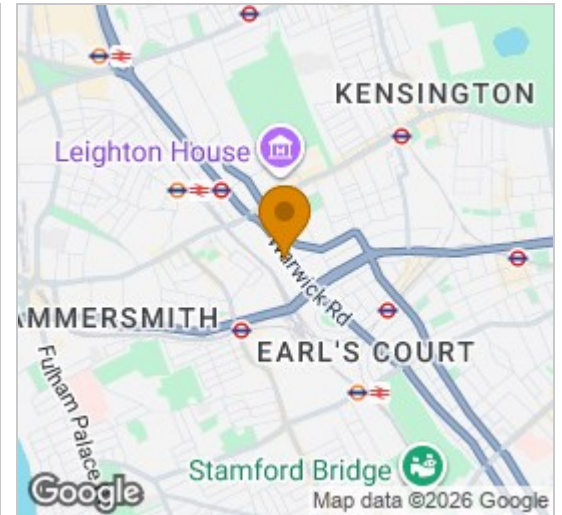

Energy Efficiency Graph

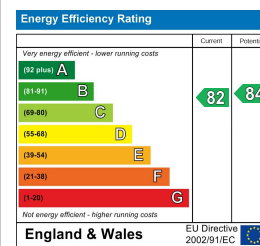

Viewing

By appointment. Contact us on 0207 052 1075 if you wish to arrange a viewing appointment for this property, or require further information.

- Exceptional apartment
- Separate kitchen
- Prestigious Kensington neighbourhood
- 1057 sq ft (98.19 sqm)
- Fully furnished to a high standard
- 24 hour porter and lift access



This exceptional two bedroom apartment, with secure parking and located in the sought after Warren House, is available for lease through Prime London.

Totalling 1,057 sq ft (98.19 sqm), the apartment boasts a generous open plan reception area with floor to ceiling windows and access to a private balcony. The kitchen is separate with integrated appliances. The master bedroom is spacious, benefiting from built in wardrobe spaces and a sleek modern ensuite.

The property is situated within Warren House, which offers residents 24 hour porter and security service.

Positioned just off Kensington High Street, the apartment is surrounded by some of London's best restaurants, cafes and boutiques.

For transport, Warren House is just a short walk away from Kensington (Olympia), West Kensington, and Earl's Court stations, which offer excellent transport links across the city.



These particulars, whilst believed to be accurate are set out as a general outline only for guidance and do not constitute any part of an offer or contract. Intending purchasers should not rely on them as statements of representation of fact, but must satisfy themselves by inspection or otherwise as to their accuracy. No person in this firm's employment has the authority to make or give any representation or warranty in respect of the property.