



Pan Peninsula Square East

3 Pan Peninsula Square, Canary Wharf, E14 9HR

Asking Price £1,800,000



Floor Plan

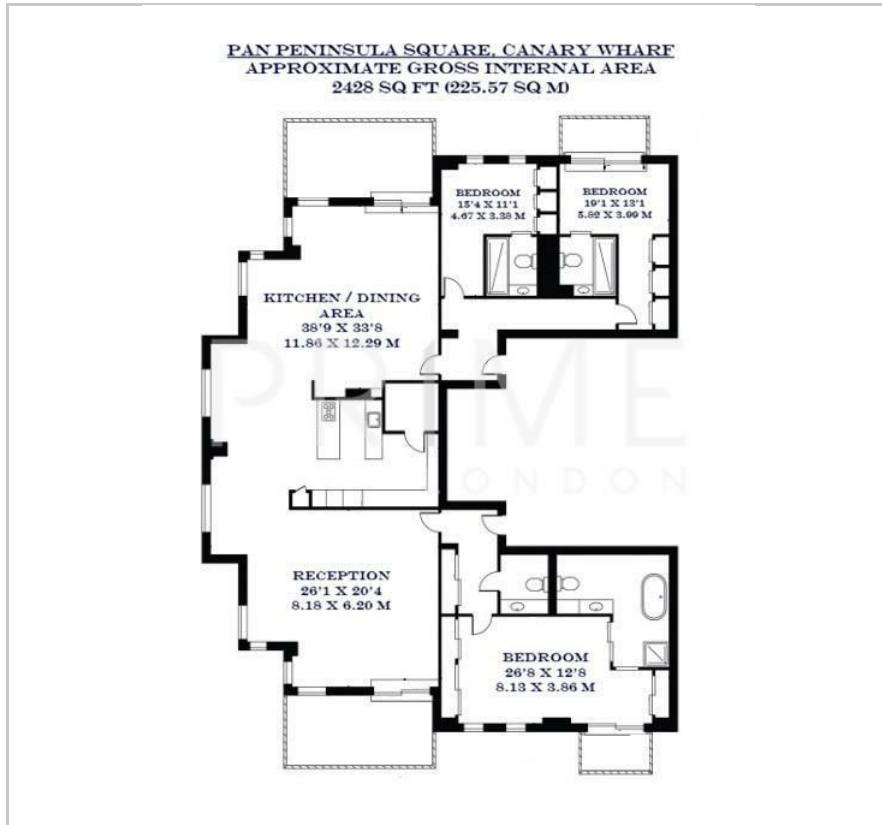

Area Map



Energy Efficiency Graph

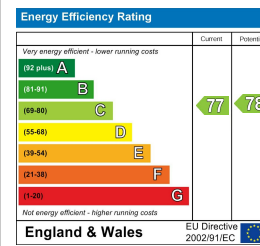

Viewing

By appointment. Contact us on 0207 928 6663 if you wish to arrange a viewing appointment for this property, or require further information.

- Three bedroom sub - penthouse
- Multiple balconies with exceptional views
- Residents' gym and pool
- 2,428 sq ft (225.57 sqm)
- 24 hour concierge
- Residents' cinema room



This stunning three bedroom sub-penthouse apartment, spanning 2,428 sq ft (214.6 sq m) within the sought-after Pan Peninsula development in Canary Wharf, is available for sale through Prime London.

The apartment is centred around a remarkable open-plan reception, kitchen and dining area, providing an outstanding space for both everyday living and large-scale entertaining. The expansive reception benefits from extensive glazing and direct access to multiple private balconies, creating a seamless connection between the indoor and outdoor spaces while maximising natural light throughout.

The impressive principal bedroom suite measures over 26 feet in length and benefits from a luxurious en-suite bathroom with separate bath and shower facilities, built-in storage and access to a private balcony. Two further generous double bedrooms are positioned in a separate wing of the apartment, each served by well-appointed bathroom facilities and benefiting from access to additional outdoor space.

A key feature of the property is the collection of four private balconies, providing multiple outdoor areas for relaxing, entertaining and enjoying views across Canary Wharf and the surrounding skyline.

Residents enjoy access to outstanding on-site facilities, including a 24 hour concierge, exclusive gym, swimming pool, cinema and residents' lounge.



These particulars, whilst believed to be accurate are set out as a general outline only for guidance and do not constitute any part of an offer or contract. Intending purchasers should not rely on them as statements of representation of fact, but must satisfy themselves by inspection or otherwise as to their accuracy. No person in this firm's employment has the authority to make or give any representation or warranty in respect of the property.